

**NUOVO DESIGN**

# SPINE E PRESE INDUSTRIALI INDUSTRIAL PLUGS AND SOCKETS

Carattere, professionalità e robustezza. La nuova gamma di spine e prese mobili per uso industriale è un connubio di qualità e design che non tradisce l'estrema funzionalità.

Elegant, professional and robust. The new range of mobile plugs and connectors for industrial use is a combination of quality and design that can also count on extreme functionality.



**NUOVO DESIGN SPINE E PRESE INDUSTRIALI**  
**NEW DESIGN INDUSTRIAL PLUGS AND SOCKETS**





# NUOVO DESIGN SPINE E PRESE INDUSTRIALI NEW DESIGN INDUSTRIAL PLUGS AND SOCKETS

28

## SPINE E PRESE 16A e 32A

**IP54 e IP66/IP67**

PLUGS AND CONNECTORS

16A and 32A

**IP54 and IP66/IP67**

**CORPO IN  
POLIAMMIDE**  
BODY IN  
POLYAMMIDE



### FORO

per facilitare i collegamenti  
in sospensione.

**BUILT-IN HANGER** to ease  
the connection with cable ties.



### APERTURA E CHIUSURA MECCANICA

rapida e pratica.  
Quick and practical  
**OPENING AND CLOSING SYSTEM.**



Contatti delle spine  
**NICHELATI.**  
**NICKEL** plated pins  
on plugs.

### LEVA

sul coperchio, per agevolare  
l'apertura con una sola mano.

**LEVER** to ease the lid opening.

**CONTATTI ALLINEATI**  
per agevolare il cablaggio.  
**ALIGNED CONTACTS**  
for an easier wiring.



**PRESSACAVO**  
meccanico e  
tenuta in gomma  
per garantire il  
grado IP.

Mechanical  
**STRAIN RELIEF**  
and rubber gasket  
to preserve the IP  
degree.



**CHIUSURA SCORREVOLE**  
a doppio filetto.  
Double thread  
**SLIDING CLOSURE.**

# NUOVO DESIGN SPINE E PRESE INDUSTRIALI NEW DESIGN INDUSTRIAL PLUGS AND SOCKETS

## SPINE E PRESE 63A e 125A

**IP66/IP67**

PLUGS AND CONNECTORS

63A e 125A

**IP66/IP67**



**PRESSACAVO SOFT TOUCH,**  
adatto ad utilizzi industriali.

**SOFT TOUCH CABLE**  
gland suitable for industrial  
applications.

### ANELLO

per facilitare i collegamenti  
in sospensione.

**BUILT-IN HANGER** to ease the  
connection with cable ties.



**CORPO IN  
POLIAMMIDE**  
BODY IN  
POLYAMMIDE

**Contatti delle spine  
NICHELATI.**

NICKEL plated pins  
on plugs.

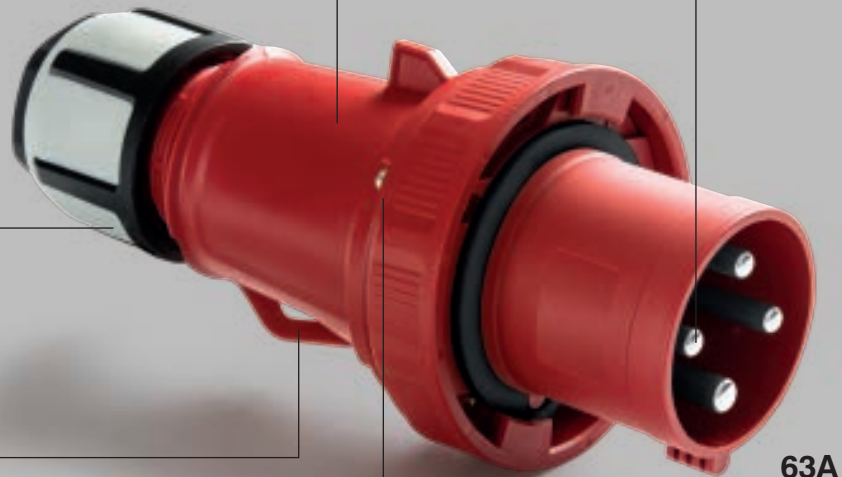

**63A**

**VITI DI CHIUSURA  
IN ACCIAIO INOX INOSSIDABILE**  
STAINLESS STEEL CLOSING SCREWS

**ERGONOMIA  
speciale del corpo  
nella versione 125A**  
per agevolare l'inserimento  
e il disinserimento.

Special **ERGONOMICS**  
in the **125A** version,  
to ease the plugging  
in and out.

**125A**

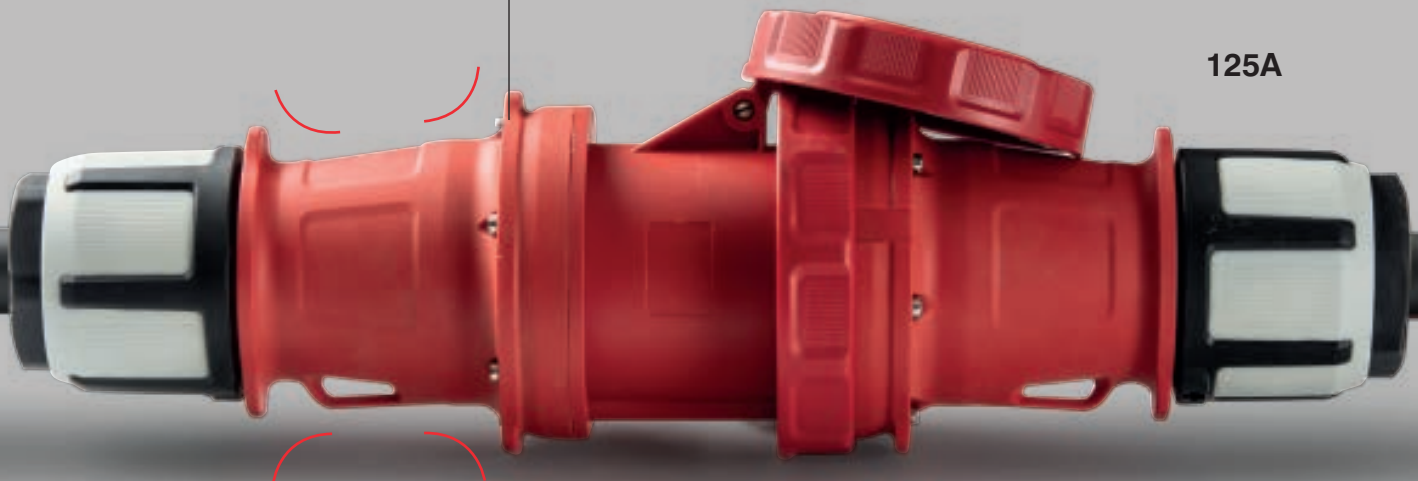

**SPINA MOBILE**  
PLUG  
**IP54**



Serie | Series 10

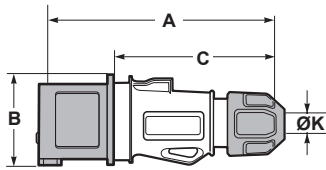

A	P	110V	230V	400V	500V	
16	3	1009101	<b>1009213*</b>			10/120
	4	1009102	1009105	<b>1009214*</b>	1009107	10/120
	5		1009111	<b>1009215*</b>	1009108	8/96
32	3	1009103	<b>1009413*</b>			5/60
	4	1009104	1009106	<b>1009414*</b>	1009109	5/60
	5			<b>1009415*</b>	1009110	4/48

P	16 Amp			32 Amp		
	3	4	5	3	4	5
A	150	150	150	172	172	172
B	56	60	73	73	73	79
C	110	110	110	125	125	125
ØK	6-15	6-15	8-16	11,5-21	11,5-21	11,5-21
Wire flexible (mm <sup>2</sup> )		1-2,5			2,5-6	

**SPINA MOBILE**  
PLUG  
**IP66/IP67**



Serie | Series 10

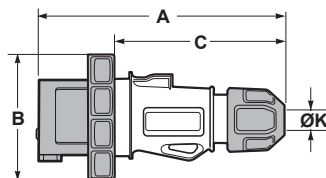

A	P	110V	230V	400V	500V	
16	3	1009151	<b>1008213</b>			10/120
	4	1009152	1009157	<b>1008214</b>	1009163	8/96
	5		1009169	<b>1008215</b>	1009164	4/48
32	3	1009153	<b>1008413</b>			4/48
	4	1009154	1009158	<b>1008414</b>	1009165	4/48
	5			<b>1008415</b>	1009166	3/36

P	16 Amp			32 Amp		
	3	4	5	3	4	5
A	150	150	150	172	172	172
B	70	78	88	92	92	100
C	110	110	110	125	125	125
Ø K	6-15	6-15	8-16	11,5-21	11,5-21	11,5-21
Wire flexible (mm <sup>2</sup> )		1-2,5			2,5-6	

**INVERTITORE**  
**DI FASE**  
PHASE INVERTER  
**IP44**



Serie | Series 10

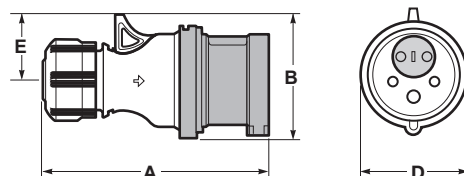

A	P	110V	230V	400V	500V	
16	5			9227		14
32	5			9229		10

	16 A	32 A
	P	5
A	132	160
B	73	86,4
D	64	64
E	38	45

**SPINA MOBILE**  
PLUG  
**IP66/IP67**

Contatto pilota incluso.  
Pilot pin is included.

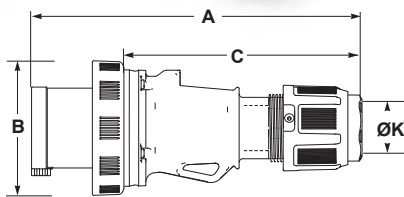

Serie | Series 10

A	P	110V	230V	400V	500V	
63	3	1009155	<b>1009159*</b>			2
	4	1009156	1009160	<b>1009161*</b>	1009167	2
	5			<b>1009162*</b>	1009168	2

P	63 Amp		
	3	4	5
A	260	260	260
B	114	114	114
C	175	175	175
Ø K	14,5-34	14,5-34	14,5-34
Wire flexible (mm <sup>2</sup> )	6-16		

**SPINA MOBILE**  
PLUG  
**IP66/IP67**

Contatto pilota incluso.  
Pilot pin is included.

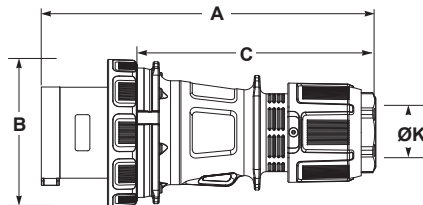

Serie | Series 10

A	P	110V	230V	400V	500V	
125	3	1009189	<b>1009170</b>			2
	4	1009190	1009191	<b>1009188*</b>	1009192	2
	5			<b>1009187*</b>	1009193	2

P	125 Amp		
	3	4	5
A	296	296	296
B	130	130	130
C	211	211	211
Ø K	23-48	23-48	23-48
Wire flexible (mm <sup>2</sup> )	16-50		

**TAPPI DI PROTEZIONE**  
PROTECTIVE CAPS  
**IP67**

Per spine 63A e 125A.  
For 63A and 125A plugs.



Applicazione | Mounted

A	P	REF.	
63	3	<b>63CAP</b>	4/80
	4		
	5		
125	3	<b>125CAP</b>	4/80
	4		
	5		

\* Articolo gestito a stock. | This product is available on stock.

## EASY ONE SPINA CABLAGGIO RAPIDO FAST WIRING PLUGS

Senza viti.  
Non è più necessario sguainare il cavo.  
Tecnologia a perforazione di isolante.  
Screwless.  
No need for cable stripping.  
With insulation perforating terminals.

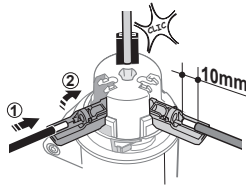

### SPINA MOBILE PLUG IP54

Cablaggio rapido  
senza viti.  
Screwless fast wiring.



A	P	110V	230V	400V	500V	
	3	1009101R	<b>1009213R*</b>			10/120
16	4	1009102R	1009105R	<b>1009214R*</b>	1009107R	10/120
	5		1009111R	<b>1009215R*</b>	1009108R	8/96



Serie | Series 10

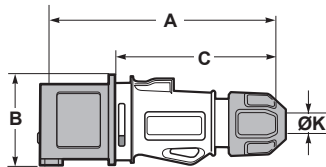

P	16 Amp		
	3	4	5
A	150	150	150
B	56	60	73
C	110	110	110
Ø K	6-15	6-15	8-16
Wire flexible (mm <sup>2</sup> )	1-2,5		

### SPINA MOBILE PLUG IP66/IP67

Cablaggio rapido  
senza viti.  
Screwless fast wiring.



A	P	110V	230V	400V	500V	
	3	1009151R	<b>1008213R*</b>			10/120
16	4	1009152R	1009157R	<b>1008214R*</b>	1009163R	8/96
	5		1009169R	<b>1008215R*</b>	1009164R	4/48



Serie | Series 10

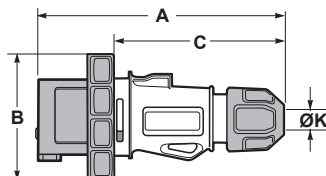

P	16 Amp		
	3	4	5
A	157	157	157
B	70	70	70
C	110	110	110
Ø K	6-15	6-15	8-16
Wire flexible (mm <sup>2</sup> )	1-2,5		



**SPINA DA INCASSO**  
PANEL PLUG  
**IP54**

Flangia | Flange 75x75 mm

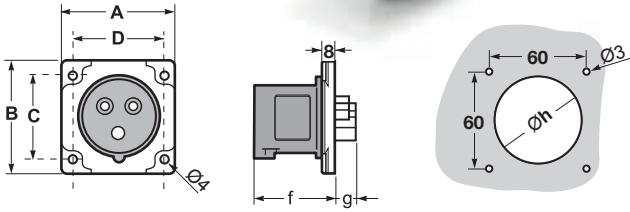

Serie | Series 10

A	P	110V	230V	400V	500V	
16	3	1001110	<b>1001107</b>			10/120
	4	1001111	1001114	<b>1001116</b>	1001119	10/120
	5			<b>1001117</b>	1001120	8/96
32	3	1001112	<b>1001108</b>			5/60
	4	1001113	1001115	<b>1001118</b>	1001121	5/60
	5			<b>1001109</b>	1001122	5/60

P	16 Amp			32 Amp		
	3	4	5	3	4	5
A	75	75	75	75	75	75
B	75	75	75	75	75	75
C	60	60	60	60	60	60
D	60	60	60	60	60	60
f	48	48	48	57	57	57
g	15	15	15	18	18	18
øh	38	38	49	49	49	49

**SPINA DA INCASSO**  
PANEL PLUG  
**IP54**

Flangia | Flange 55x55 mm

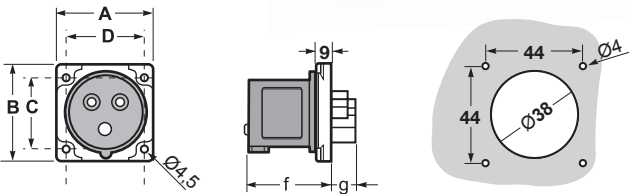

Serie | Series 10

A	P	110V	230V	400V	500V	
16	3	1001110S	<b>1001107S</b>			10/120
	4	1001111S	1001114S	<b>1001116S</b>	1001119S	10/120

P	16 Amp	
	3	4
A	55	55
B	55	55
C	44	44
D	44	44
f	48	48
g	15	15

**SPINA DA INCASSO**  
PANEL PLUG  
**IP54**

Contatto pilota incluso.  
Pilot pin is included.

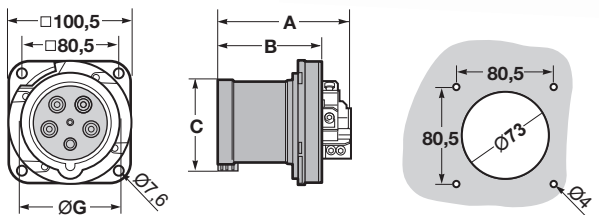

Serie | Series 10

A	P	110V	230V	400V	500V	
63	3		<b>1001140</b>			10
	4			<b>1001141</b>		10
	5			<b>1001142</b>		10

P	63 Amp		
	3	4	5
A	110,8	110,8	110,8
B	83,9	83,9	83,9
C	75	75	75
G	69,4	69,4	69,4

\* Articolo gestito a stock. | This product is available on stock.



**SPINA DA PARETE**  
WALL PLUG  
**IP54**



A	P	110V	230V	400V	500V	
16	3	1001173	<b>1001177</b>			3/36
	4	1001174	1001178	<b>1001181</b>	1001185	3/36
	5			<b>1001182</b>	1001186	3/36
32	3	1001175	<b>1001179</b>			3/36
	4	1001176	1001180	<b>1001183</b>	1001187	3/36
	5			<b>1001184</b>	1001188	3/36

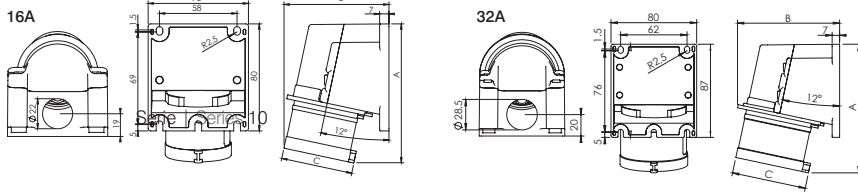

P	16 Amp			32 Amp		
	3	4	5	3	4	5
A	108	109	117	127	127	130
B	110	112	116	118	118	121
C	60	68	76	81	81	89

**SPINA DA PARETE**  
WALL PLUG  
**IP54**



A	P	110V	230V	400V	500V	
16	3	1001123	<b>1001127</b>			3/36
	4	1001124	1001128	<b>1001131</b>	1001135	3/36
	5			<b>1001132</b>	1001136	3/36
32	3	1001125	<b>1001129</b>			2/24
	4	1001126	1001130	<b>1001133</b>	1001137	2/24
	5			<b>1001134</b>	1001138	2/24

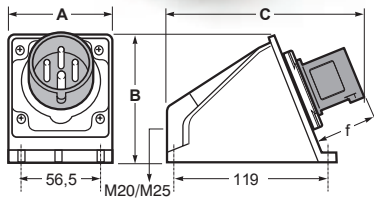

Serie | Series 10

P	16 Amp			32 Amp		
	3	4	5	3	4	5
A	81	81	81	81	81	81
B	97	97	97	97	97	97
C	151	151	151	151	151	151
f	48	48	48	57	57	57
Wire flexible (mm²)	1-2,5			2,5-6		

**SPINA DA PARETE**  
**A 90°**  
WALL 90° ANGLED  
PLUG  
**IP54**



A	P	110V	230V	400V	500V	
16	3	1001011	<b>1001012</b>			4/48
	4	1001013	1001014	<b>1001015</b>	1001016	4/48
	5		1001027	<b>1001021</b>	1001024	2/24
32	3	1001017	<b>1001019</b>			2/24
	4	1001018	1001020	<b>1001022</b>	1001025	2/24
	5			<b>1001023</b>	1001026	2/24

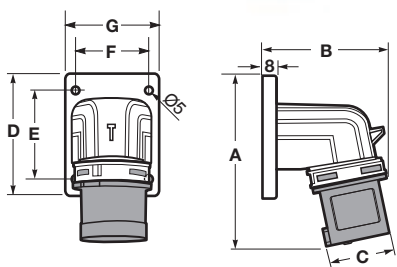

Serie | Series 10

P	16 Amp			32 Amp		
	3	4	5	3	4	5
A	118	118	118	160	160	160
B	87	87	93	107	107	110
C	46,5	53,5	60,5	62,5	62,5	69,5
D	86	86	86	101	101	101
E	60,5	60,5	60,5	85	85	85
F	52	52	52	78	78	78
G	65,5	65,5	65,5	91	91	91

**SPINA DA PARETE  
A 90°  
WALL 90° ANGLED  
PLUG  
IP66/IP67**

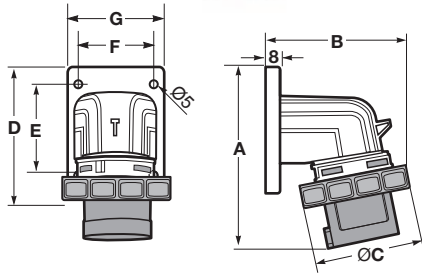

Serie | Series 10

A	P	110V	230V	400V	500V	
16	3	1001051	<b>1001052</b>			4/48
	4	1001053	1001054	<b>1001055</b>	1001056	4/48
	5		1001075	<b>1001065</b>	1001070	2/24
32	3	1001057	<b>1001061</b>			2/24
	4	1001058	1001062	<b>1001066</b>	1001071	2/24
	5			<b>1001067</b>	1001072	2/24

P	16 Amp			32 Amp		
	3	4	5	3	4	5
A	118	118	118	160	160	160
B	97	99	104	108	108	110
C	71	77	87	92	92	98
D	86	86	86	101	101	101
E	60,5	60,5	60,5	85	85	85
F	52	52	52	78	78	78
G	65,5	65,5	65,5	91	91	91

**SPINA DA PARETE  
A 90°  
WALL 90° ANGLED PLUG  
IP66/IP67**

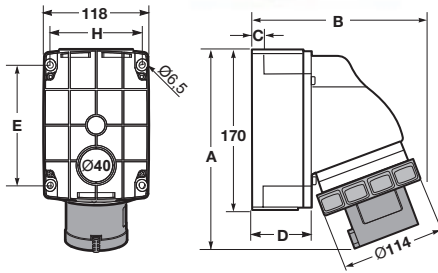

Serie | Series 10

A	P	110V	230V	400V	500V	
63	3	1001060	<b>1001063</b>			3
	4	1001059	1001064	<b>1001068</b>	1001073	3
	5			<b>1001069</b>	1001074	3

P	16 Amp		
	3	4	5
A	227,5	227,5	227,5
B	184	184	184
C	14	14	14
D	63,5	63,5	63,5
E	136	136	136
F	134	134	134
G	102,5	102,5	102,5
H	103,5	103,5	103,5

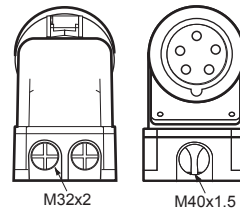

**SPINA DA PARETE A 90°  
WALL 90° ANGLED PLUG  
IP66/IP67**

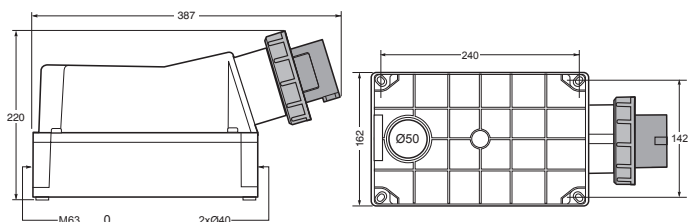

Serie | Series 10

A	P	110V	230V	400V	500V	
125	3	1084	<b>1081</b>			1
	4	1085	1086	<b>1082</b>	1087	1
	5			<b>1083</b>	1088	1

**PRESA MOBILE  
SOCKET  
IP54**



Serie | Series 11

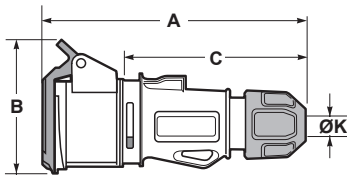

A	P	110V	230V	400V	500V	
16	3	1009001	<b>1009223*</b>			10/120
	4	1009002	1009005	<b>1009224*</b>	1009007	10/120
	5		1009526	<b>1009225*</b>	1009008	4/48
32	3	1009003	<b>1009523*</b>			4/48
	4	1009004	1009006	<b>1009524*</b>	1009009	4/48
	5			<b>1009525*</b>	1009010	3/36

P	16 Amp			32 Amp		
	3	4	5	3	4	5
A	157	157	157	178	178	178
B	85	91	97	105	105	105
C	110	110	110	125	125	125
Ø K	6-15	6-15	8-16	11,5-21	11,5-21	11,5-21
Wire flexible (mm <sup>2</sup> )	1-2,5			2,5-6		

**PRESA MOBILE  
SOCKET  
IP66/IP67**



Serie | Series 11

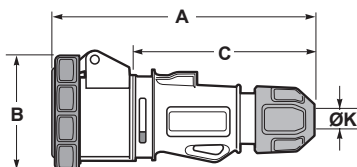

A	P	110V	230V	400V	500V	
16	3	1009051	<b>1008223*</b>			10/120
	4	1009052	1009057	<b>1008224*</b>	1009063	6/72
	5		1009069	<b>1008225*</b>	1009064	4/48
32	3	1009053	<b>1008523*</b>			3/36
	4	1009054	1009058	<b>1008524*</b>	1009065	3/36
	5			<b>1008525*</b>	1009066	3/36

P	16 Amp			32 Amp		
	3	4	5	3	4	5
A	165	157	157	170	170	170
B	80	85	95	97	99	106
C	110	110	110	125	125	125
Ø K	6-15	6-15	6-15	11,5-21	11,5-21	11,5-21
Wire flexible (mm <sup>2</sup> )	1-2,5			2,5-6		

**PRESA MOBILE  
SOCKET  
IP66/IP67**



Serie | Series 10



Standard: senza contatto pilota.  
Per richiederlo aggiungere una "P" finale al codice.  
Standardly: not provided with pilot pin. In case you need it, just add a "P" at the end of the standard code.

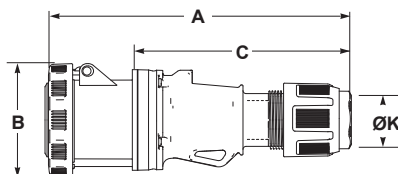

A	P	110V	230V	400V	500V	
63	3	1009055	<b>1009059</b>			2
	4	1009056	1009060	<b>1009061</b>	1009067	2
	5			<b>1009062</b>	1009068	2

P	63 Amp		
	3	4	5
A	260	260	260
B	110	110	110
C	175	175	175
Ø K	14,5-34	14,5-34	14,5-34
Wire flexible (mm <sup>2</sup> )	6-16		

**PRESA MOBILE**  
**SOCKET**  
**IP66/IP67**



Serie | Series 10

Standard: senza contatto pilota.  
 Per richiederlo aggiungere una  
 "P" finale al codice.

Standardly: not provided with  
 pilot pin. In case you need it,  
 just add a "P" at the end of the  
 standard code.

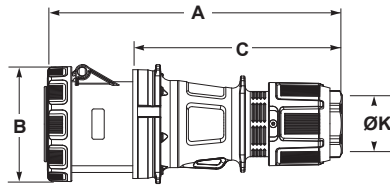

A	P	110V	230V	400V	500V	
	3	1009089	<b>1009070</b>			2
125	4	1009090	1009091	<b>1009088</b>	1009092	2
	5			<b>1009087</b>	1009093	2

P	125 Amp		
	3	4	5
A	316	316	316
B	122	122	122
C	217	217	217
ØK	23-48	23-48	23-48
Wire flexible (mm <sup>2</sup> )	16-50		

\* Articolo gestito a stock. | This product is available on stock.



# EASY ONE PRESE CABLAGGIO RAPIDO SOCKET FAST WIRING

Senza viti.  
Non è più necessario sguainare il cavo.  
Tecnologia a perforazione di isolante.  
Screwless.  
No need for cable stripping.  
With insulation perforating terminals.

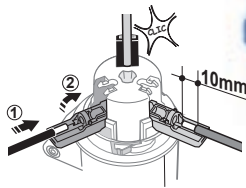

## PRESA MOBILE SOCKET IP54

Cablaggio rapido  
senza viti.  
Screwless fast wiring.



A	P	110V	230V	400V	500V	
	3	1009001R	<b>1009223R*</b>			10/120
16	4	1009002R	1009005R	<b>1009224R*</b>	1009007R	10/120
	5		1009526R	<b>1009225R*</b>	1009008R	4/48



Serie | Series 11

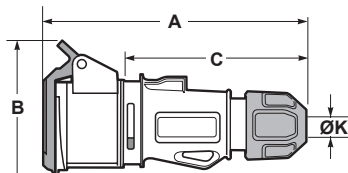

P	16 Amp		
	3	4	5
A	157	157	157
B	85	91	97
C	110	110	110
ØK	6-15	6-15	8-16
Wire flexible (mm <sup>2</sup> )	1-2,5		

## PRESA MOBILE SOCKET IP66/IP67

Cablaggio rapido  
senza viti.  
Screwless fast wiring.



A	P	110V	230V	400V	500V	
	3	1009051R	<b>1008223R*</b>			10/120
16	4	1009052R	1009057R	<b>1008224R*</b>	1009063R	6/72
	5		1009069R	<b>1008225R*</b>	1009064R	4/48



Serie | Series 11

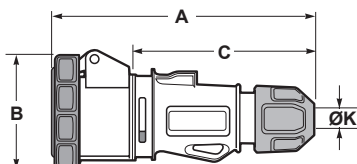

P	16 Amp		
	3	4	5
A	157	157	157
B	70	70	70
C	110	110	110
ØK	6-15	6-15	8-16
Wire flexible (mm <sup>2</sup> )	1-2,5		

**PRESA DA INCASSO**  
**DRITTA**  
 STRAIGHT PANEL  
 SOCKET  
**IP66/IP67**

Flangia | Flange **55x55 mm**



A	P	110V	230V	400V	500V	
16	3	1001301S	<b>1001302S</b>			10/120
	4	1001303S	1001304S	<b>1001305S</b>	1001306S	10/120

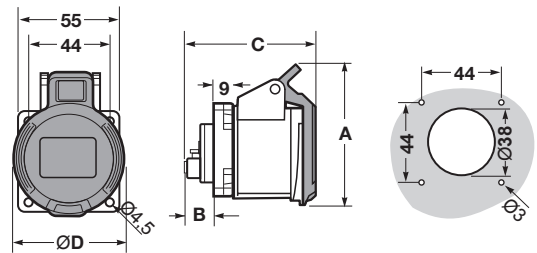

Serie | Series 11

	16 Amp	
	P	
A	3	4
B	81	87
C	18	18
D	76	78
	60	68

**PRESA DA INCASSO**  
**DRITTA**  
 STRAIGHT PANEL  
 SOCKET  
**IP66/IP67**

Flangia | Flange **55x55 mm**



A	P	110V	230V	400V	500V	
16	3	1001351S	<b>1001352S</b>			10/120
	4	1001353S	1001354S	<b>1001355S</b>	1001356S	10/120

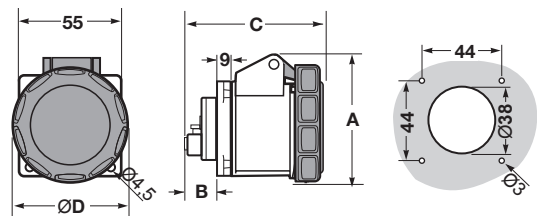

Serie | Series 11

	16 Amp	
	P	
A	3	4
B	79	86
C	18	18
D	80	79
	60	68

\* Articolo gestito a stock. | This product is available on stock.



**PRESA DA INCASSO  
DRITTA**  
STRAIGHT PANEL  
SOCKET  
**IP66/IP67**



Serie | Series 11

Standard: senza contatto pilota. Per richiederlo aggiungere una "P" finale al codice.

Standardly: not provided with pilot pin. In case you need it, just add a "P" at the end of the standard code.

A	P	110V	230V	400V	500V	
63	3	1001359	<b>1001363</b>			5
	4	1001360	1001364	<b>1001368</b>	1001373	5
	5			<b>1001369</b>	1001374	5

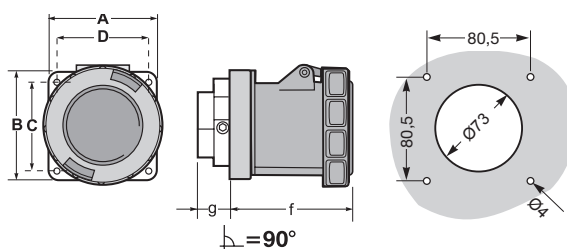

P	63 Amp		
	3	4	5
A	102	102	102
B	27	27	27
C	111	111	111
D	101	101	101
E	80,5	80,5	80,5

**PRESA DA INCASSO  
DRITTA**  
STRAIGHT PANEL  
SOCKET  
**IP66/IP67**



Serie | Series 11

Standard: senza contatto pilota. Per richiederlo aggiungere una "P" finale al codice.

Standardly: not provided with pilot pin. In case you need it, just add a "P" at the end of the standard code.

A	P	110V	230V	400V	500V	
125	3	1379	<b>1377</b>			2
	4	1378	1380	<b>1375</b>	1381	2
	5			<b>1376</b>	1382	2

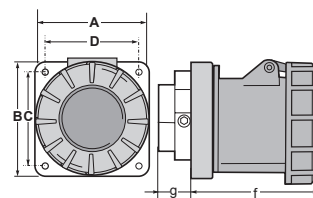

P	125 Amp		
	3	4	5
A	120	120	120
B	120	120	120
C	100	100	100
D	100	100	100
F	101	101	101
G	48	48	48
Wire flexible (mm <sup>2</sup> )	16-50		



**PRESA DA INCASSO  
 INCLINATA  
 SLOPING PANEL  
 SOCKET  
 IP54**



A	P	110V	230V	400V	500V	
16	3	1006007Q	<b>1006001Q*</b>			10/120
	4	1006008Q	1006013Q	<b>1006002Q*</b>	1006020Q	10/120
	5		1006014Q	<b>1006003Q*</b>	1006021Q	8/96
32	3	1006009Q	<b>1006004Q*</b>			5/60
	4	1006010Q	1006015Q	<b>1006005Q*</b>	1006022Q	5/60
	5			<b>1006006Q*</b>	1006023Q	5/60

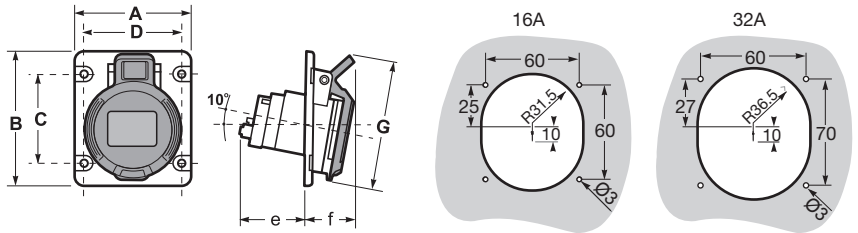

P	16 Amp			32 Amp		
	3	4	5	3	4	5
A	75	75	75	80	80	80
B	85	85	85	95	95	95
C	60	60	60	70	70	70
D	60	60	60	60	60	60
e	45	45	45	60	60	60
f	26	34	37	40	40	40
G	86	94	102	108	108	108



Serie | Series 11

**PRESA DA INCASSO  
 INCLINATA  
 SLOPING PANEL  
 SOCKET  
 IP66/IP67**



A	P	110V	230V	400V	500V	
16	3	1007007Q	<b>1007001Q*</b>			10/120
	4	1007008Q	1007013Q	<b>1007002Q*</b>	1007020Q	8/96
	5		1007014Q	<b>1007003Q*</b>	1007021Q	8/96
32	3	1007009Q	<b>1007004Q*</b>			5/60
	4	1007010Q	1007015Q	<b>1007005Q*</b>	1007022Q	5/60
	5			<b>1007006Q*</b>	1007023Q	5/60

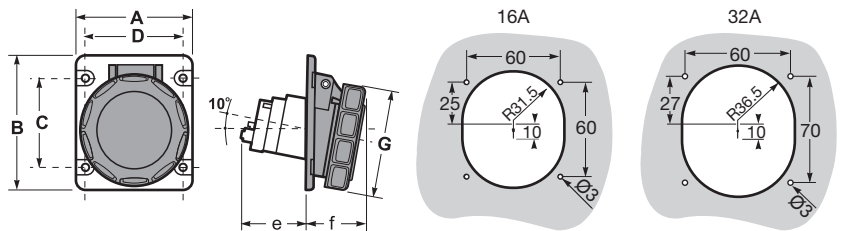

P	16 Amp			32 Amp		
	3	4	5	3	4	5
A	75	75	75	80	80	80
B	85	85	85	95	95	95
C	60	60	60	70	70	70
D	60	60	60	60	60	60
E	45	45	45	60	60	60
F	26	34	37	40	40	40
G	70	78	85	92	92	99,5



Serie | Series 11

**PRESA DA INCASSO  
 INCLINATA  
 SLOPING PANEL  
 SOCKET  
 IP66/IP67**

A	P	110V	230V	400V	500V	
	3	1007011Q	<b>1007016Q*</b>			10
63	4	1007012Q	1007017Q	<b>1007018Q*</b>	1007024Q	10
	5			<b>1007019Q*</b>	1007025Q	10

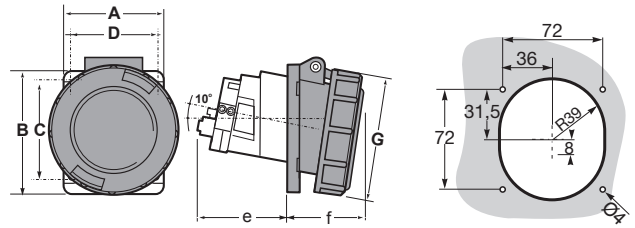

Serie | Series 11

Standard: senza contatto pilota. Per richiederlo aggiungere una "P" finale al codice.

Standardly: not provided with pilot pin. In case you need it, just add a "P" at the end of the standard code.

P	63 Amp		
	3	4	5
A	85	85	85
B	100	100	100
C	72	72	72
D	72	72	72
e	83	83	83
f	58	58	58
G	110	110	110
Wire flexible (mm <sup>2</sup> )	6-16		

Flangia di ridotte dimensioni per risparmiare spazio all'interno di soluzioni assiemate.

Small flange to save space on compact wired solutions or boxes.

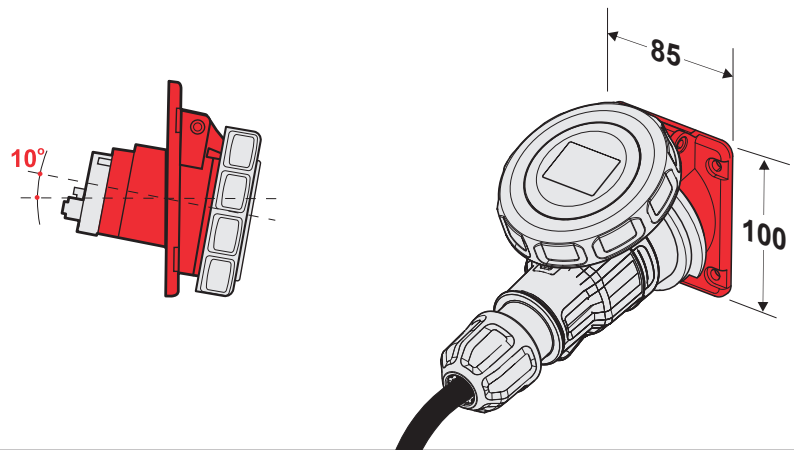

\* Articolo gestito a stock. | This product is available on stock.

# PRESE DA PARETE COMPACT

## WALL SOCKET COMPACT VERSION

### IP54

**FACILE DA MONTARE**  
Solo 3 parti.

**EASY TO WIRE**  
Only 3 parts.

**FACILE DA CABLARE**  
frutto presa libero.

**EASY TO WIRE** no obstacles to the connecting part.



**PIÙ COMPATTE**  
MORE COMPACT

**VITI IMPERDIBILI**  
CAPTIVE SCREWS

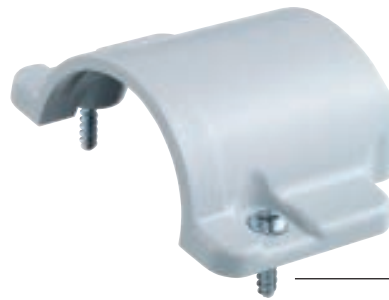

**PASSACAVO UNIVERSALE**  
che permette l'ingresso di cavi di varie dimensioni.  
**UNIVERSAL CABLE ENTRY**  
suitable for different cable dimensions.

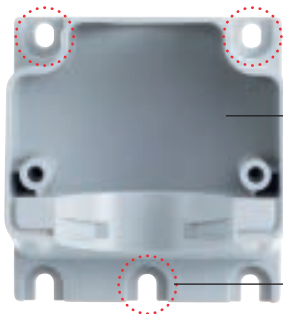

**INTERNO STAGNO**  
THE INTERNAL PART IS SEALED

**POSSIBILITÀ DI FISSAGGIO**  
anche solo con 3 viti.  
It is **POSSIBLE TO FIX** with 3 screws only.

**PRESE INDUSTRIALI | Prese da parete**  
**INDUSTRIAL SOCKETS | Wall sockets**

A	P	110V	230V	400V	500V	
	3	1002531	<b>1002532</b>			5/60
16	4	1002533	1002534	<b>1002535</b>	1002536	4/48
	5			<b>1002545</b>	1002550	3/36
	3	1002537	<b>1002541</b>			3/36
32	4	1002538	1002542	<b>1002546</b>		3/36
	5			<b>1002547</b>		3/36



16A  
3P-4P

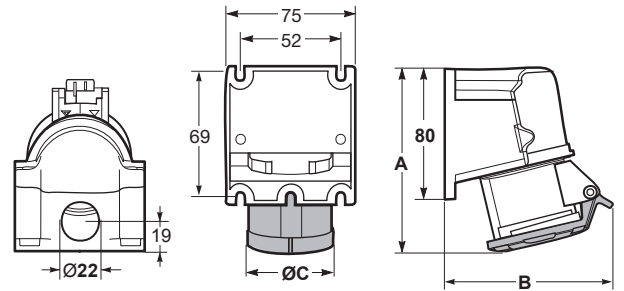

16A  
5P  
32A  
3P-4P-5P

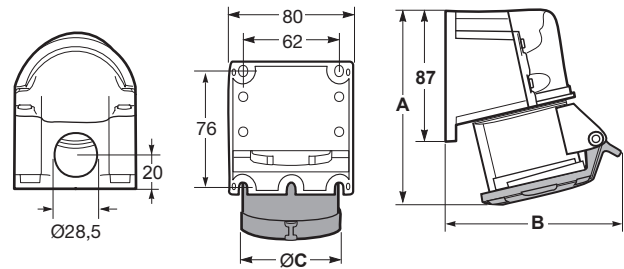

Serie | Series 11

P	16 Amp			32 Amp		
	3	4	5	3	4	5
A	108	109	117	127	127	130
B	110	112	116	118	118	121
C	60	68	76	81	81	89



**PRESA DA PARETE**  
**WALL SOCKET**  
**IP54**



Ingresso del cavo chiuso per garantire la tenuta stagna.  
 Closed cable entry, to guarantee the IP degree.



Centraggio nella parte inferiore.  
 Centering on the bottom surface.

Serie | Series 11

A	P	110V	230V	400V	500V	
16	3	1002501	<b>1002502</b>			3/36
	4	1002503	1002504	<b>1002505</b>	1002506	3/36
	5			<b>1002515</b>	1002520	3/36
32	3	1002507	<b>1002511</b>			2/24
	4	1002508	1002512	<b>1002516</b>	1002521	2/24
	5			<b>1002517</b>	1002522	2/24

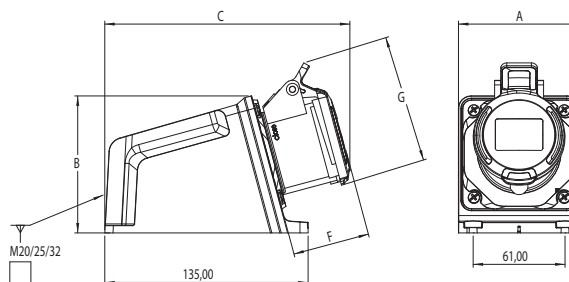

P	16 Amp			32 Amp		
	3	4	5	3	4	5
A	80,5	80,5	80,5	80,5	80,5	80,5
B	91	91	91	91	91	91
C	163	164	165	175	175	176
G	85	92	101	105	105	112
F	52	52	52	62	62	62
Wire flexible (mm <sup>2</sup> )	1-2,5			2,5-6		

**PRESA DA PARETE**  
**WALL SOCKET**  
**IP66/IP67**



Ingresso del cavo chiuso per garantire la tenuta stagna.  
 Closed cable entry, to guarantee the IP degree.



Centraggio nella parte inferiore.  
 Centering on the bottom surface.

Serie | Series 11

A	P	110V	230V	400V	500V	
16	3	1002551	<b>1002552</b>			3/36
	4	1002553	1002554	<b>1002555</b>	1002556	3/36
	5			<b>1002565</b>	1002570	3/36
32	3	1002557	<b>1002561</b>			2/24
	4	1002558	1002562	<b>1002566</b>	1002571	2/24
	5			<b>1002567</b>	1002572	2/24

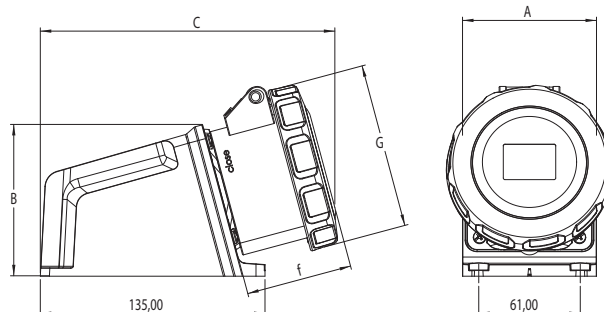

P	16 Amp			32 Amp		
	3	4	5	3	4	5
A	80,5	80,5	80,5	80,5	80,5	80,5
B	91	91	91	91	91	91
C	167	168	168	177	177	177
G	70	77	87	92	92	99
F	56	56	56	64	64	64
Wire flexible (mm <sup>2</sup> )	1-2,5			2,5-6		

**PRESA DA PARETE**  
**WALL SOCKET**  
**IP66/IP67**

A	P	110V	230V	400V	500V	
	3	1001259	<b>1001263</b>			3
63	4	1001260	1001264	<b>1001268</b>	1001273	3
	5			<b>1001269</b>	1001274	3

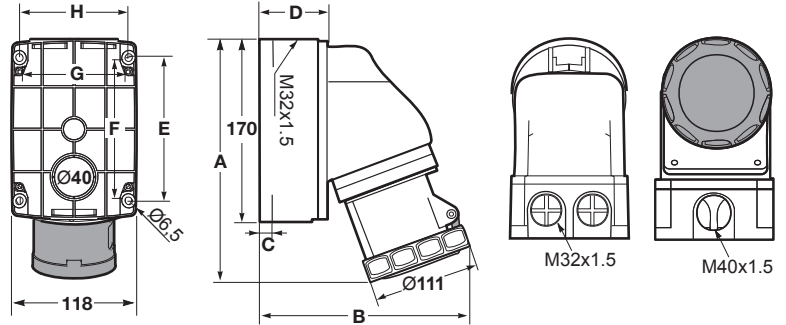

Serie | Series 11

Standard: senza contatto pilota. Per richiederlo aggiungere una "P" finale al codice.

Standardly: not provided with pilot pin. In case you need it, just add a "P" at the end of the standard code.

	63 Amp			
	P	3	4	5
A		232	232	232
B		200	200	200
C		14	14	14
D		63,5	63,5	63,5
E		136	136	136
F		134	134	134
G		102,5	102,5	102,5
H		103,5	103,5	103,5

**PRESA DA PARETE**  
**WALL SOCKET**  
**IP66/IP67**

A	P	110V	230V	400V	500V	
	3	1279	<b>1278</b>			1
125	4	1280	1281	<b>1277</b>	1282	1
	5			<b>1276</b>	1283	1

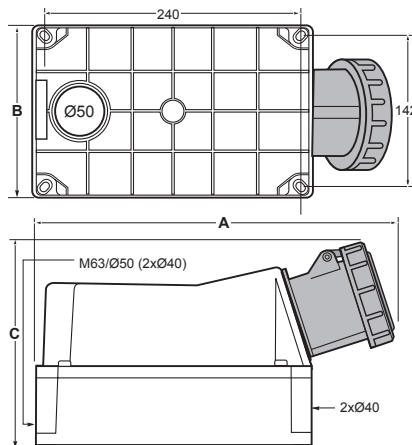

Serie | Series 11

Standard: senza contatto pilota. Per richiederlo aggiungere una "P" finale al codice.

Standardly: not provided with pilot pin. In case you need it, just add a "P" at the end of the standard code.

	125 Amp			
	P	3	4	5
A		322	322	322
B		162	162	162
C		220	220	220
D		60	60	60
Wire flexible (mm²)		16-50		

**PRESA DA PARETE  
 INCLINATA  
 SLOPING WALL  
 SOCKET  
 IP54**



A	P	110V	230V	400V	500V	
16	3	11.1401	<b>11.1402</b>			3/36
	4	11.1403	11.1404	<b>11.1405</b>	11.1406	3/36
	5			<b>11.1415</b>	11.1420	3/36
32	3	11.1407	<b>11.1411</b>			3/36
	4	11.1408	11.1412	<b>11.1416</b>	11.1421	3/36
	5			<b>11.1417</b>	11.1422	3/36

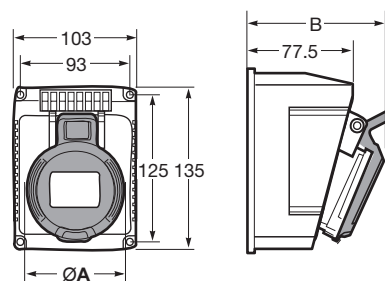

Serie | Series 11

P	16 Amp			32 Amp		
	3	4	5	3	4	5
A	60	68	76	81	81	89
B	103	104	105	113	113	115

**PRESA DA PARETE  
 INCLINATA  
 SLOPING WALL  
 SOCKET  
 IP66/IP67**



A	P	110V	230V	400V	500V	
16	3	11.1451	<b>11.1452</b>			3/36
	4	11.1453	11.1454	<b>11.1455</b>	11.1456	3/36
	5			<b>11.1465</b>	11.1470	3/36
32	3	11.1457	<b>11.1461</b>			3/36
	4	11.1458	11.1462	<b>11.1466</b>	11.1471	3/36
	5			<b>11.1467</b>	11.1472	3/36

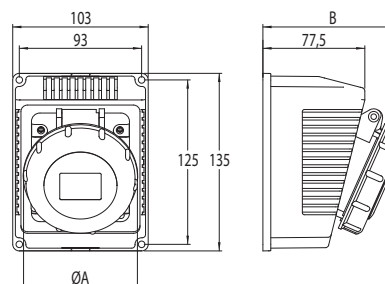

Serie | Series 11

P	16 Amp			32 Amp		
	3	4	5	3	4	5
A	71	77	87	92	92	98
B	100	100	106	112	112	112

**PRESA DA PARETE “DUO”**  
**“DUO” WALL SOCKET**  
**IP54**

Presa Schuko completa di cavi interni.  
 32A 5P con fusibile 5x20 mm 10A 250V  
 su presa Schuko.

Schuko socket complete with internal  
 cables. 32A 5P is equipped with a fuse  
 5x20 mm 10A 250V on Schuko socket.

A	P	110V	230V	400V	500V	
16	3		<b>1002502-SCH</b>			6
	4			<b>1002505-SCH</b>		6
	5			<b>1002515-SCH</b>		5
32	3		<b>1002511-SCH</b>			5
	4			<b>1002516-SCH</b>		5
	5			<b>1002517-SCH</b>		5

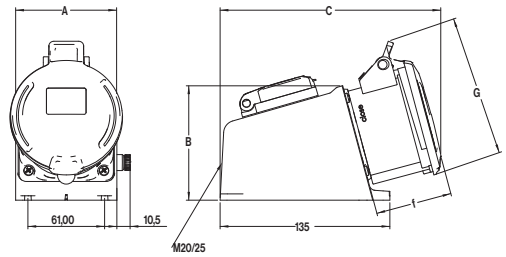

Serie | Series 11

Per altre configurazioni, contattare il  
 produttore.

Should you need different configurations,  
 please ask the manufacturer.

P	16 Amp		
	3	4	5
A	80,5	80,5	80,5
B	91	91	91
C	175	175	175
G	105	105	112
f	62	62	62
Wire flexible (mm <sup>2</sup> )	2,5-6		